

BC8611
V-Hush™ Rocker



Perfect for babies aged over 3 months.

vtech®

Quick start guide

TECHNICAL SPECIFICATIONS

Power requirements	Rocker power adaptor: Input: 100-240V~50/60Hz 0.15A; Output: 5V DC 1A Non-user replaceable built-in battery: 3.6V, 2600mAh Li-ion, 9.36Wh Li-ion battery
--------------------	---

WHAT'S IN THE BOX

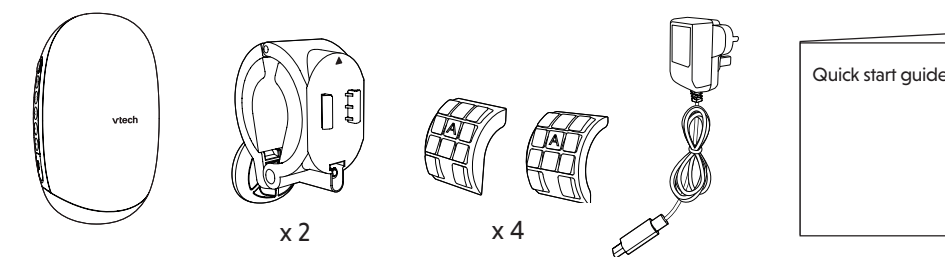

IMPORTANT SAFETY INSTRUCTIONS

The applied nameplate is located on the back of the Rocker. When using your equipment, basic safety precautions should always be followed to reduce the risk of fire, electric shock and injury, including the following:

- Follow all warnings and instructions marked on the product.
- Adult setup is required.
- This product is intended as an aid. It is not a substitute for responsible and proper adult supervision and should not be used as such.
- This product is not intended for use as a medical device.
- Do not use this product near water. For example, near to a bath, sink, swimming pool or shower.
- CAUTION:** Use only the internal, non-user replaceable battery fitted to the Rocker. There may be a risk of explosion if a wrong type of battery is used in the Rocker. The battery cannot be subjected to high or low extreme temperature and low air pressure at high altitude during use, storage or transportation. Disposal of batteries in fire or a hot oven, mechanically crushing or cutting the battery can result in an explosion. Subjecting products or batteries to an extremely high temperature environment can result in explosion or leakage of flammable liquids, or gas. Products or batteries subjected to extremely low air pressures may result in explosion or leakage of flammable liquids, or gas.
- Use only the adaptor included with this product. Incorrect adaptor polarity or voltage can seriously damage the product.

Power adaptor information:
Input: 100-240V~50/60Hz 0.15A Output: 5V DC 1A
Vtech Telecommunications Ltd.
Model: VT05EUK05100

-OR-
Jiangxi Jian Aohai Technology Co., Ltd.
Model: A318-050100W-UK2

Rechargeable battery information:
Zhuhai Great Power Energy Co., Ltd.
Li-ion battery, 3.6V, 2600mAh, 9.36Wh;
Model: ICR18650-2.6Ah-3.6V-1S1P

- The power adaptor is intended to be correctly oriented in a vertical or floor mount position. The prongs are not designed to hold the plug in place if it is plugged into a ceiling, under-the-table or cabinet outlet.
- For pluggable equipment, the socket-outlet (power adaptor) should be installed near the equipment and should be easily accessible.
- Unplug this product from the wall outlet before cleaning. Do not use liquid or aerosol cleaners. Use a damp cloth for cleaning.
- Charging should only be done by an adult.
- Do not modify the power adaptors or replace with other third-party adaptors.
- Do not allow anything to rest on the power cords. Do not install this product where the cords may be walked on or damaged.
- The product should only be operated from a power source indicated on the power adaptor label or marking. If you are unsure of the type of power supply in your home, consult your dealer or electricity supply provider.

- Do not overload wall outlets or use an extension cord.
- Do not place this product on an unstable table, shelf, stand or other unstable surfaces.
- This product should not be placed in any area where proper ventilation is not provided. Any slots or openings in the back or bottom of this product are provided for ventilation. To protect from overheating, openings must not be blocked by placing the product on a soft surface such as a bed, sofa or rug. This product should never be placed near or over a radiator or heat source.
- Never insert any objects through any apertures or slots in the product as this can be dangerous and cause damage to the battery or other internal parts. Never spill any liquids on the product.
- To reduce the risk of electric shock, do not disassemble this product, but take it to an authorised service facility. Disassembling or removing parts of the product other than battery replacement via a battery door (if applicable) may expose dangerous voltages or other risks.
- Periodically examine all components for damage.
- Children should be supervised to ensure that they do not play with the product.
- The small parts of this device can be swallowed by babies or small children. Keep these parts out of reach of children.
- The product is not intended for use by persons (including children) with reduced physical, sensory or mental capabilities, or lack of experience and knowledge, unless they have been given supervision or instruction concerning use of the appliance by a person responsible for their safety.

SAVE THESE INSTRUCTIONS

- Cautions**
- Use and store the product at a temperature between 0°C and 40°C.
 - Do not expose the product to extreme cold, heat or direct sunlight. Do not put the product close to a heating source.
 - Mishandling batteries can cause burn, fire or explosion hazards.
 - Batteries should not be exposed to excessive heat such as bright sunshine or fire.
 - Warning—Strangulation Hazard—Children have STRANGLED in cords. Keep this cord out of the reach of children (more than 0.9m away). Do not remove warning label on the adaptor cord.
 - Never place the Rocker inside the baby's cot or playpen. Never cover the Rocker with anything such as a towel or a blanket.

1 CONNECT AND CHARGE THE ROCKER

NOTES

- The rechargeable battery in the Rocker is built-in.
- Only use the power adaptor supplied with this product.
- Make sure the Rocker is not connected to an electronically/timer-controlled electric power outlet.
- Connect the power adaptor in a vertical or floor mount position only. The adaptor prongs are not designed to hold the weight of the Rocker.
- Make sure the Rocker and the power adaptor cord are out of reach of children.

Lift and rotate the rubber cap to allow the power adaptor connector to be inserted, connect the power adaptor to the Rocker and a power supply, then it charges automatically.

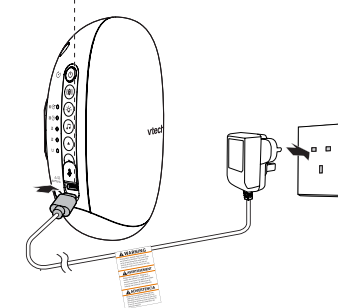
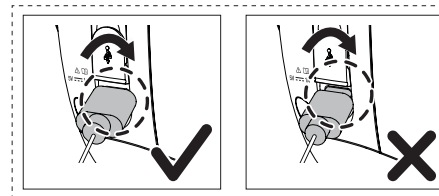

NOTES

- Before using the Rocker for the first time, charge the battery a minimum of 4 hours.
- Rocker can work up to 6 hours at the lowest rocking speed. The standby time between uses will depend on the battery charge available. This varies according to the rocking speed, night light use, lullaby use and the age of the battery.
- You cannot use the Rocker while charging.

The LEDs indicate the battery status during charging as shown in the table:

Battery Charging status	LED indicators
< 20%	L1 LED indicator flashes.
< 40%	L1 indicator turns on steadily, L2 flashes.
< 60%	L1 and L2 indicators turn on steadily, L3 flashes.
< 80%	L1, L2 and L3 indicators turn on steadily, Timer 30 indicator flashes.
< 100%	L1, L2, L3 and Timer 30 indicators turn on steadily, and Timer 60 indicator flashes.
Fully charged	All LED indicators turn on steadily.

2 INSTALLING THE ROCKER

CAUTION

- Keep the Rocker out of reach of your baby. Never place the Rocker inside the baby's cot or playpen.

NOTE

- For your convenience, this product is supplied with a spare clamp to avoid the need to remove and reinstall from one pushchair to another.

(Optional) Changing rubber pads to fit your stroller:

- The pre-fitted rubber pads fit stroller handlebar diameters from 26 to 33 millimetres. For larger handlebars, use the larger pads for 34 to 41 millimetres.
- When changing the rubber pads, look for the marking "A" on the rubber pad. Make sure to match this marking with the mounting bracket during installation.
- Remove the pre-fitted rubber pads and insert the new rubber pads, ensuring that marking "A" is aligned.

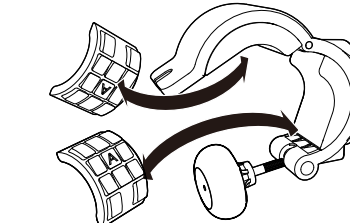
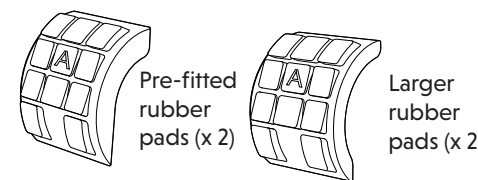

Install Rocker onto the stroller:

- Find a convenient area away from a wall and secure your stroller with the brakes. Turn the knob anti-clockwise to unscrew the mounting bracket.

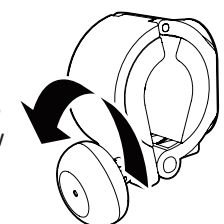

- Clamp the mounting bracket to the stroller handlebar, and turn the knob clockwise until it locks firmly.

NOTE

- Remember to keep a firm grip or the rocker can fall off.

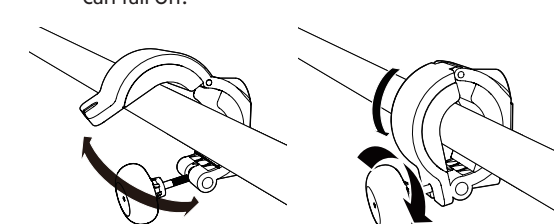

- Align the markings on both components and position the Rocker's mounting slots over the two bracket tangs. Slide it down until it locks firmly in place. Rotate the Rocker until it is in a vertical position with the nightlight downwards.

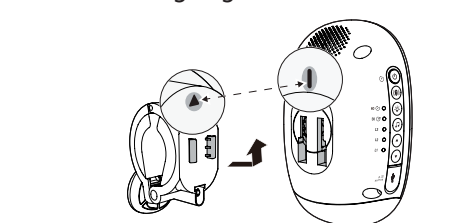

- Note that the rocking movement is horizontal, so positioning Rocker vertically, ensures optimal performance.

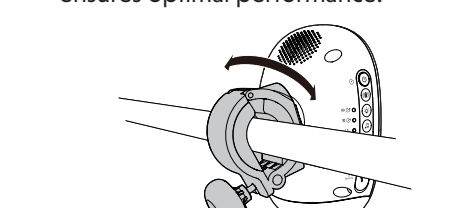

Scan to see a video showing the complete installation.

CAUTION

- Always position the Rocker vertically for optimal performance.
- Please lock the stroller wheels before starting the rocking motion. If the wheels are not locked, the stroller may move, posing a risk to your baby.

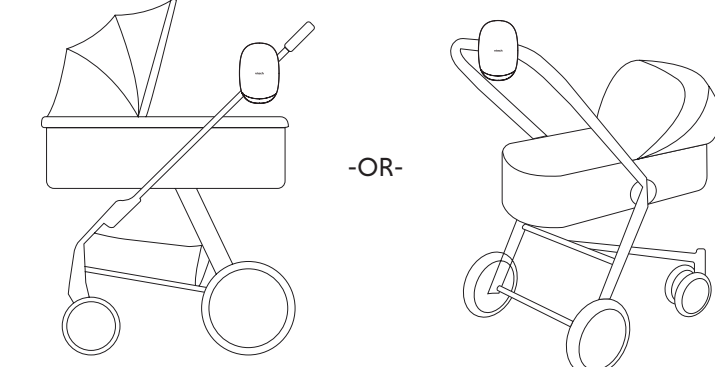
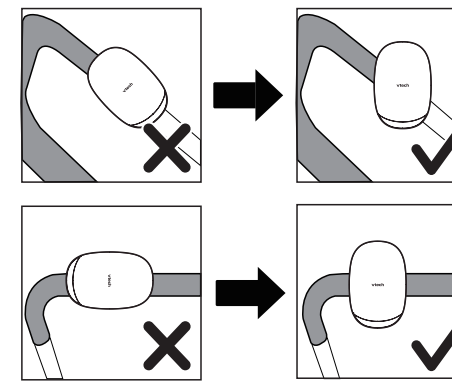

To remove the Rocker,

- Rotate the Rocker on the mounting clamp until the clamp knob is nearest the night light and slide the Rocker upwards from the mounting bracket.
- Rotate the knob anti-clockwise to unscrew the mounting bracket. (for convenience, you can also leave the clamp in place.)

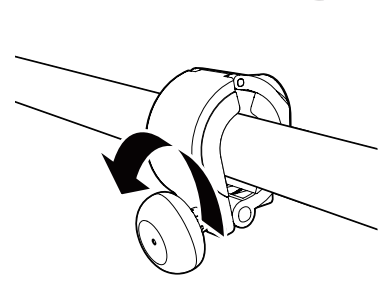
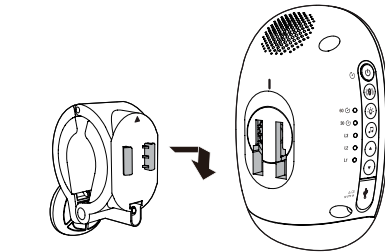

OVERVIEW

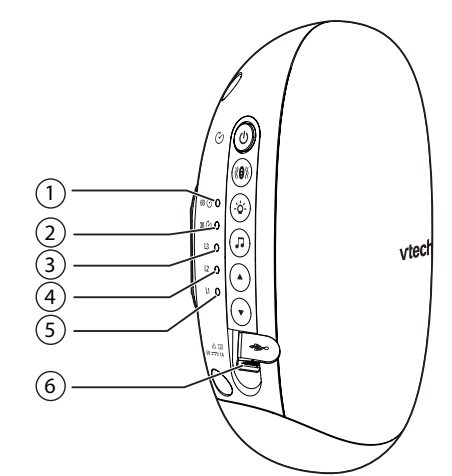

1/2 60 / 30 Timer indicator

3/4/5 Rocking speed indicator

- L3 Highest speed
- L2 Medium speed
- L1 Lowest speed

6 USB Charging port (under rubber cover)

7 Speaker

8 Mounting slots

9 Power / Timer

- Press and hold to turn on the Rocker.
- Press to select the rocking timer.
- Press and hold to turn off the Rocker.

10 Rocking motion key

- Press to turn rocking motion on.
- Press to select rocking speed L1/ L2/ L3, or turn off the motion.

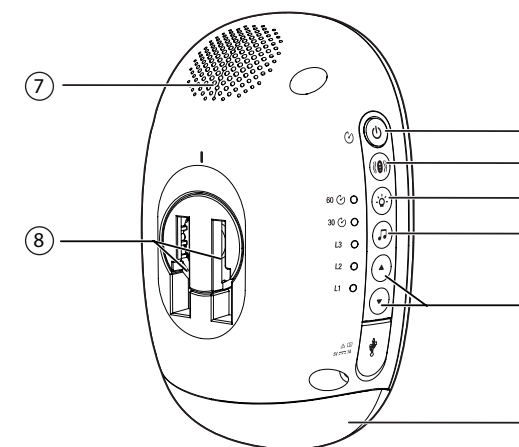

11 Night light control key

- Press to turn the night light on or off.
- Press to toggle the night light brightness between two levels.

12 Audio key

- Press to sequentially play the lullabies and natural sounds. (The sequence is White noise, River, 1st Lullaby, 2nd Lullaby, Birds.) After playing all the audio, press again will stop the audio.
- Press and hold to stop the audio.

13 Vol + / Vol -

- Press to increase or decrease the Rocker speaker volume when playing a lullaby or natural sound.

14 Night light

USING THE ROCKER

Power on the Rocker

Press and hold the **Power** key to turn your Rocker on when the Rocker is not connected to the USB-C charger. All the LED indicators will momentarily turn on, then off, leaving only an Auto-off timer LED illuminated.

Press and hold **Power** to turn the Rocker off.

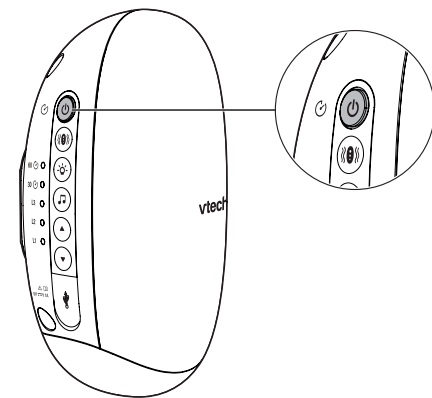

NOTES

- The Rocker has an IPX2 water resistance rating, meaning it can withstand water droplets, but is not designed for heavy rain.
- The Rocker retains your previous soothing settings after turning off.

Rocking Motion

When your baby cries or cannot sleep, you can relax your baby with three rocking motion levels available on the Rocker.

- Press **Rocking Motion** to start rocking your baby.
- Press **Rocking Motion** again to select the rocking speed level: L1 (Lowest speed), L2 (Medium speed) and L3 (Highest speed). The corresponding level LED indicator will illuminate.
- Press **Rocking Motion** in L3 to turn off rocking motion.

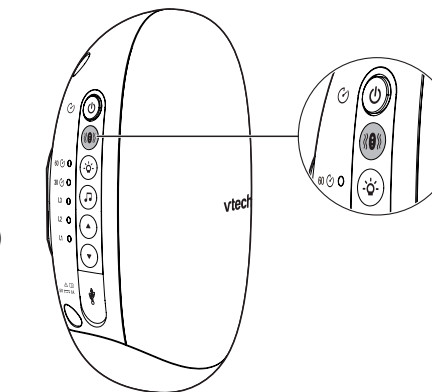

When the battery is low:

- If the rocking motion is on, the selected timer and the rocking speed LED indicators turn on steadily and other speed LEDs flash.
- If the rocking motion is off, the preset timer LED turns on steadily, and all other speed LED indicators flash.

NOTE

- Rocker emits a slight mechanical sound from the case when rocking motion is turned on. This is normal.

Auto-off Timer

While the Rocker is rocking your baby, playing a lullaby or natural sound, the auto-off timer feature helps you automatically stop the rocking motion, night light and audio after 30 or 60 minutes.

- Press **Auto-off Timer** to toggle timer options between 30 minutes and 60 minutes. The 60 or 30 timer LED indicator will illuminate and the Rocker will start to count down.

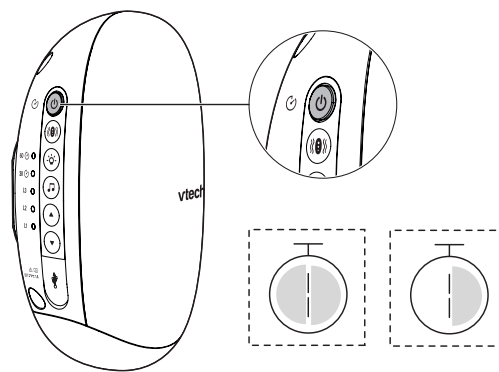

Audio Player

There are 2 lullabies and 3 natural sounds pre-stored in the Rocker.

Press **Audio Player** to play the audio, press **Audio Player** repeatedly to sequentially select the lullabies and natural sounds. The sequence is White noise, River, 1st Lullaby, 2nd Lullaby, Birds.

After you have sequentially selected all 2 lullabies and 3 natural sounds, pressing **Audio Player** again will stop the audio. Alternatively, press and hold **Audio Player** to stop the audio.

You can press **Volume Up** or **Volume Down** to increase or decrease the volume from 5 available levels. The Rocker will emit a short beep when the volume is set to the maximum or minimum level.

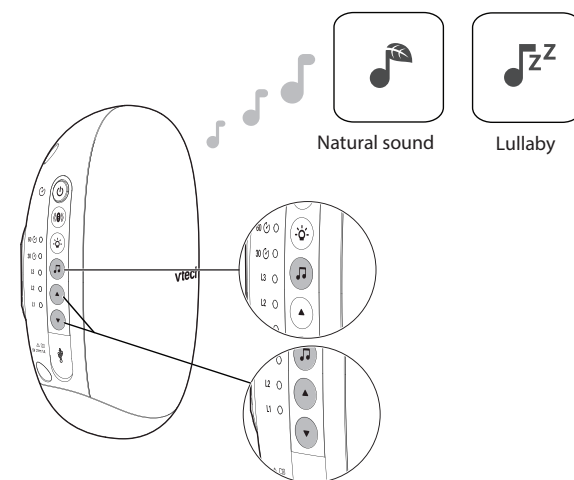

Night Light

With the night light, the Rocker can illuminate a soft hue to calm your baby in a dark room. You can control the brightness level of its glow directly on the Rocker.

- Press **Night Light** to turn on the night light.
- Press **Night Light** to toggle the brightness between 50% and 100%.
- Press **Night Light** again to turn off the night light.

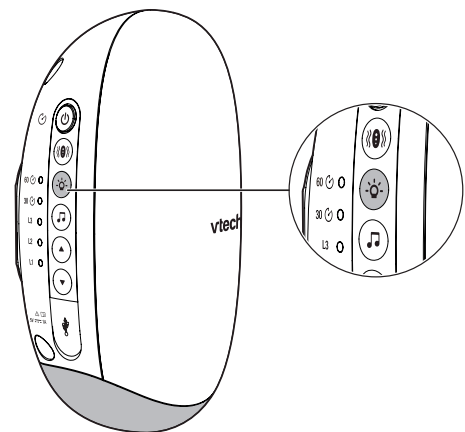

Q&A FREQUENTLY ASKED QUESTIONS

Below are the questions most frequently asked about the Rocker.

How is the Rocker attached to a stroller?	You can install the Rocker to a stroller's handlebar using the included mounting bracket. This bracket can be left on the stroller permanently or removed and adjusted as needed. The Rocker easily slots in and out of the bracket. To attach it, simply clamp the mounting bracket to the stroller's handlebar, tighten the knob clockwise, and slide the Rocker onto the bracket. You can also rotate the Rocker on the bracket to position it vertically.
What should I do if my Rocker won't charge?	If your Rocker isn't charging, verify the following: <ul style="list-style-type: none"> Ensure you are using the adaptor included with this product. Do not use fast chargers or cables. Incorrect adaptor polarity or voltage can seriously damage the product.
Does Rocker work while charging?	While charging, the Rocker cannot be used and the charger USB-C lead must be removed before Rocker can be used.
What if my Rocker has trouble starting?	If your Rocker does not start, or if you need to press the button multiple times to start, check that it's fully charged. Also make sure that it is rotated so that it is in a vertical position with the nightlight downwards.
Is the rocking motion safe for my baby?	Yes, we designed the rocking motion to replicate how parents rock their children by hand. The vibration level closely mimics the natural hand rocking action of a stroller.
Why is there a 30/60 minute timer on the Rocker?	For your convenience, the timer automatically turns off Rocker after selectable times of 30 or 60 minutes. This can be particularly useful during busy times when you forget to turn Rocker off and avoids unnecessary battery drain.
How long does it take to charge the Rocker?	It takes 4 hours to fully charge Rocker which provides around 6 hours use at the lowest rocking speed.

CUSTOMER SERVICE AND PRODUCT WARRANTY



PRODUCT WARRANTY

Thank you for choosing this quality product from VTech.

- The product detailed above is covered by a one year warranty from the date of purchase, against any defects in materials or workmanship.
- The product may be returned to the place of purchase.
- If the product covered by this warranty is damaged due to misuse, modification or unauthorised repair, or because of faulty batteries, battery discharge or incorrect electrical connections, then this warranty becomes void.
- This warranty is personal to the original purchaser and is not transferable.
- Breakages to the case is not covered by the warranty.

Email: service-ukbm@vtechphones.eu

VTech Electronics Europe Plc, c/o XPO Logistics, Warehouse 350, Cat & Fiddle Lane, West Hallam, DE7 6HE

THIS WARRANTY IS OFFERED AS AN EXTRA BENEFIT AND DOES NOT AFFECT CONSUMERS' STATUTORY RIGHTS.

This warranty is valid for the UK and Ireland only. For products purchased outside the UK and Ireland, please contact your local distributor or place of purchase.

IMPORTANT

Please retain the receipt as proof of the date of purchase.

Customer Service

Please visit www.vtechphones.eu to contact our Customer Service Department.

Manufacturer: VTech Telecommunications Ltd.
23/F., Tai Ping Industrial Centre, Block 1, 57 Ting kok Road, Tai Po, Hong Kong.
Importer: VTech Electronics Europe Plc
Napier Court, Abingdon Science Park, Abingdon, Oxon, OX14 3YT, U.K.

GENERAL PRODUCT CARE

To keep this product working well and looking good, please follow these guidelines:

- Avoid placing near heating appliances and devices that generate electrical noise (for example, motors or fluorescent lamps).
- DO NOT expose to direct sunlight or moisture.
- Avoid dropping the product or treating it roughly.
- Clean with a soft damp cloth.
- DO NOT immerse the Rocker in water and do not clean under running water.
- DO NOT use solvents, household cleaning sprays, or liquid cleaners.
- Make sure the Rocker is dry before reconnecting to the mains supply.

STORAGE

When you are not intending to use the Rocker for some time, store the product and the adaptor in a cool, dry place.

DISPOSAL OF BATTERIES AND PRODUCT

- The crossed-out wheelite bin symbols on products and batteries, or on their respective packaging, indicates that they must not be disposed of with domestic waste as they contain substances that can be damaging to the environment and human health.
- The chemical symbols Hg, Cd or Pb, where marked, indicate that the battery contains more than the specified value of mercury (Hg), cadmium (Cd) or lead (Pb) set out in Battery Directive (2006/66/EC).
- The solid bar indicates that the product was placed on the market after 13th August, 2005.
- Help protect the environment by disposing of your product or batteries responsibly.

DECLARATION OF CONFORMITY

This product is intended for use within Europe and UK.
This equipment complies with the essential requirements of EU Radio Equipment Directive (2014/53/EU) and the UK Radio Regulations 2017 on radio systems and telecommunication equipment.
VTech Telecommunications Ltd. hereby declares that V-Hush™ Rocker BC8611 complies with the essential requirements and other relevant provisions of EU Radio Equipment Directive (2014/53/EU) and UK Radio Equipment Regulations 2017.
The Declaration of Conformity for the V-Hush™ Rocker BC8611 is available from www.vtechphones.eu.



Specifications are subject to change without notice.
© 2024 VTech Telecommunications Ltd.
All rights reserved. 09/24. BC8611_UK_QSG_V1

